

THINKWARE DASH CAM™

Quick Start Guide

ARC 900

Power the Dash Cam

Use one of the following options

The included cable options vary depending on the dash cam model purchased.



12V Power Cable



Hardwiring Cable*



OBD-II Cable*



*To enable Parking Surveillance mode, the dash cam needs to be powered by either the OBD-II Cable or Hardwiring Cable (professional installation recommended).

Download the App

Download the THINKWARE DASH CAM LINK App

On your smartphone, open the Google Play Store or Apple App Store, then download and install **THINKWARE DASH CAM LINK**.



**THINKWARE
DASH CAM LINK**



App Download

Install the Front Camera

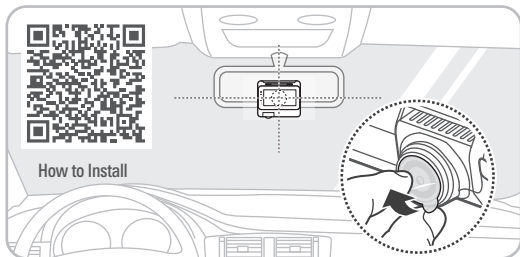

Tap the Home menu (⋮) button > **Settings** > **Road Safety Settings**, and then select a **Vehicle Type**. Follow the instructions on the ADAS Front Camera Guide screen to adjust the front camera's angle.



Install the Rear Camera



Attach the product with the THINKWARE logo facing indoors.

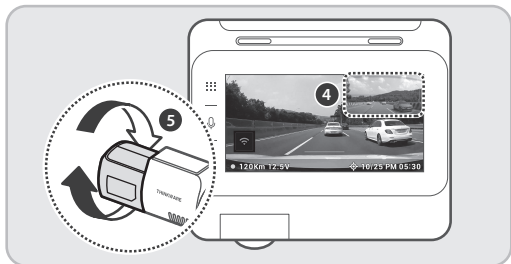
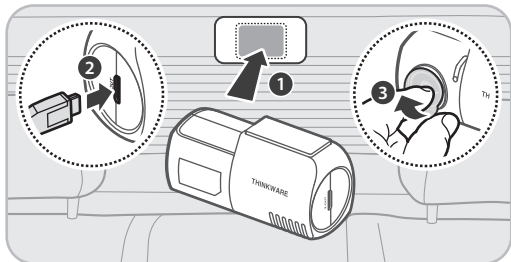



Connect to the App

Follow the on-screen instructions

1. Run **THINKWARE DASH CAM LINK**.



2. Tap **Dash Cam Registration** and select **ARC900** from the dash cam model list.
3. Press the Wi-Fi  icon on the dash cam you want to connect to, then press the  icon twice. To skip these steps in the future, select **Do not show again**.



4. Scan the QR code and follow the instructions in the app to connect.



5. If connecting via QR code fails, connect manually using Wi-Fi.



Press the the Wi-Fi  icon on the dash cam to check the Wi-Fi network name and password.

Dash Cam Settings

Default settings out of the box

The default settings are listed below, with options to adjust them based on your preferences.

Options	Description	
Night Vision	Parking Mode	
HDR	ON	
Voice Recording	ON	
Parking Mode	Motion Detection (Select from Motion Detection/Energy Saving/OFF)	
Battery Protection	ON	
Off Voltage	Regular	12.1 V
	Adjust the settings according to your vehicle type.	
Safety Cameras	OFF	
Front Security LED	Disabled	
Rear Security LED	Disabled	
Speed Stamp	OFF	

FAQ & Help Desk

Still have questions or issues?

For further assistance or to report any issues, please contact our support team.

- **North America**
1 (844) 865-9273
support@thinkware.com
- **United Kingdom**
44 (0) 333-121-0008
support.eu@thinkware.com
- **European Union**
(+49) 69-943-22200
support@thinkwarestore.com
- **APAC & Global**
support@thinkware.com



FAQs & Help Desk



User Guide

Please refer to **CS Information QR** in the box for other countries.